

DOUBLE-SIDE MOBILE SCREEN WHITEBOARD

INSTALLATION INSTRUCTIONS

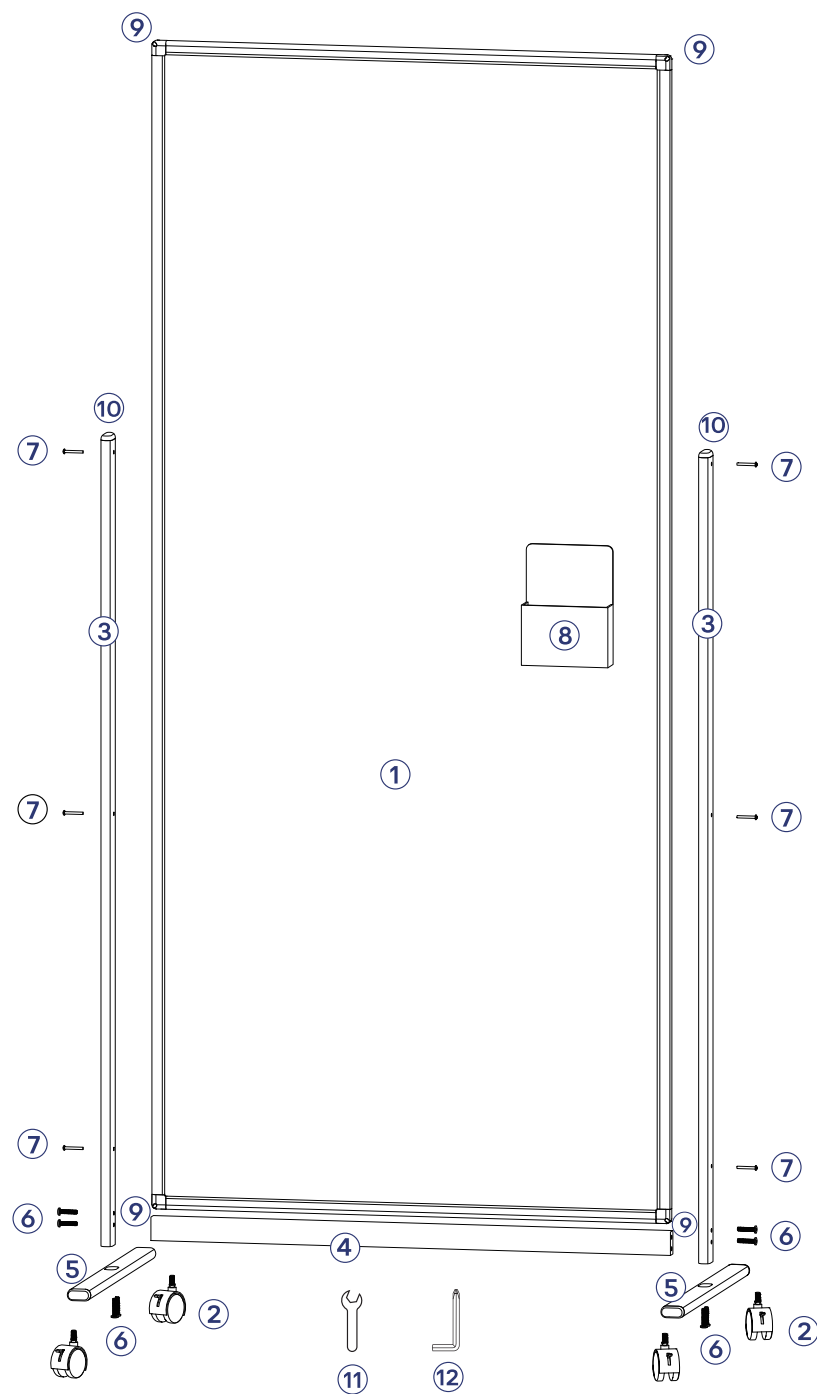

PARTS LIST

PART NUMBER	PART NAME	AMOUNT	PART NUMBER	PART NAME	AMOUNT
①	Whiteboard	1	⑦	M4*30mm screw	7
②	Castor wheel	4	⑧	Pen holder	1
③	Column	2	⑨	Decorative cover	8
④	Crossbar	1	⑩	Plug	6
⑤	Foot bar	2	⑪	Spanner	1
⑥	M6*35mm screw	9	⑫	Wrench	1

INSTALLATION STEPS

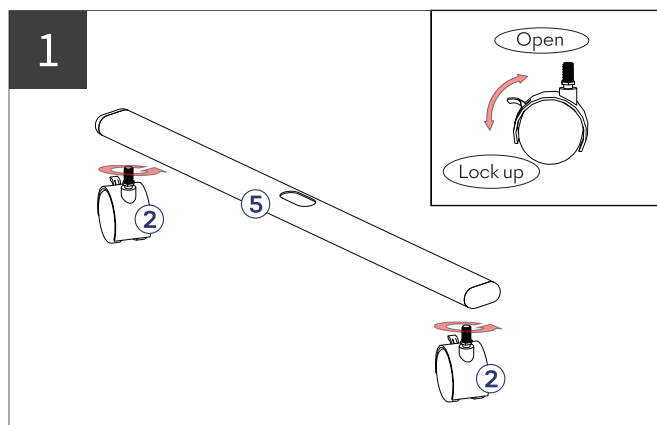

Install the castor wheels (2) on the foot bar (5)

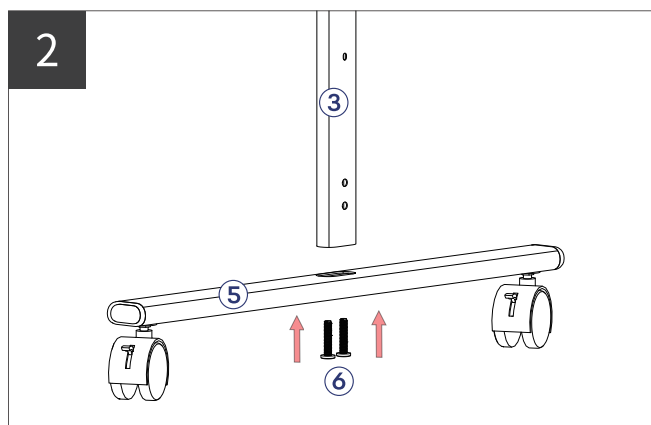

Install the foot bar (5) on the column (3) by M6*35mm screws (6)

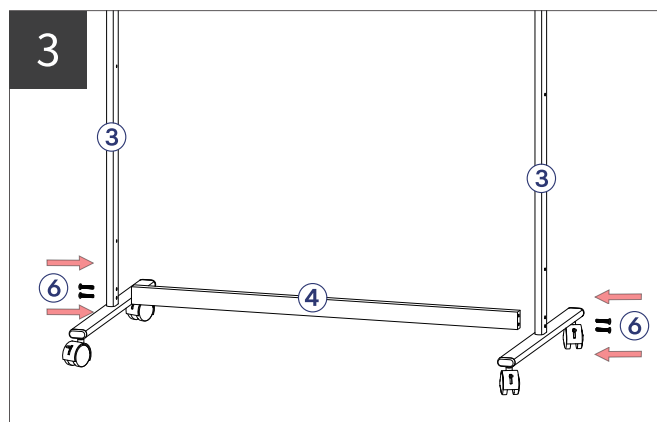

Connect the crossbar (4) on the installed columns (3) by M4*35mm screws (6)

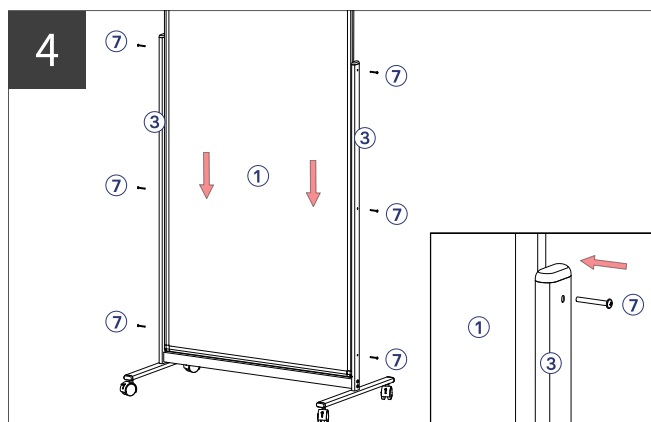

Install the whiteboard (1) between the two columns (3) from top to bottom by M4*30mm screws (7)

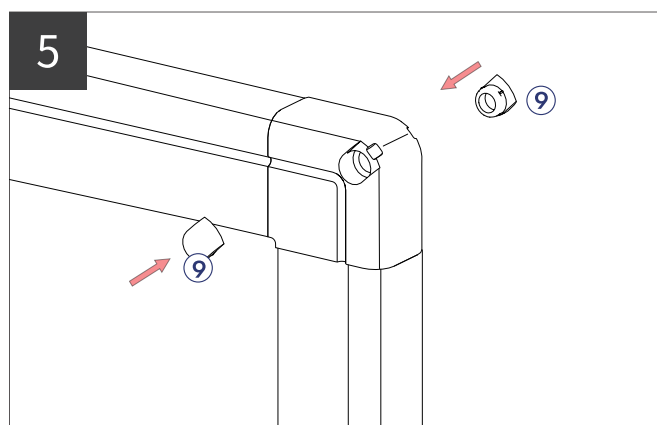

Install the decorative covers (9) on the four ABS corners of the whiteboard

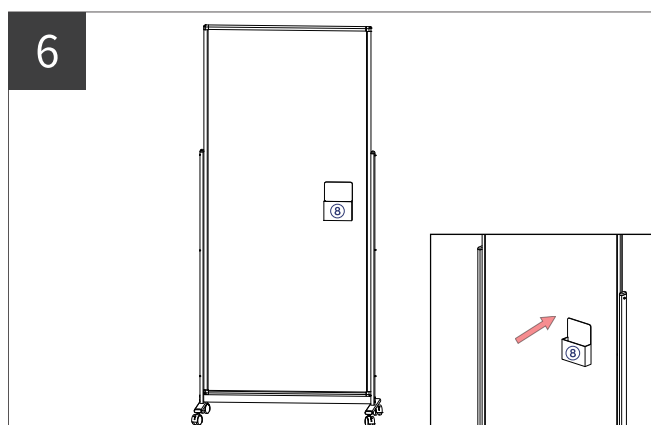

Suck the pen holder (8) anywhere on the whiteboard for your convenience. Product installation completed.

Caution!

Do not allow children under three years old to contact with the small parts inside of the package, avoid swallowing;
Avoid injury during installation;

Keep the spare parts.